

770090-1 Product Details

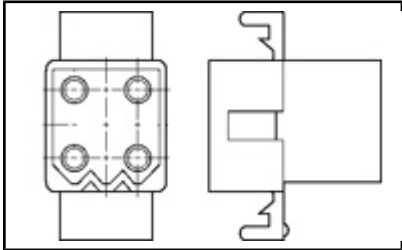

770090-1



[Active](#)

.198, .200, .250" Centerline, 250 V, 13 A max.



[Always EU RoHS/ELV Compliant \(Statement of Compliance\)](#)

Product Highlights:

- Housing
- Plug
- 5.03 mm Centerline
- Number of Circuits = 6
- Matrix Contact Layout

[View all Features](#) | [Find Similar Products](#)

NEW!

Documentation & Additional Information

Product Drawings:

- [PLUG, 6 CIRCUIT](#), (PDF, English)

Catalog Pages/Data Sheets:

- [SOFT SHELL PIN AND SOCKET CONNECTORS](#) (PDF, English)

Product Specifications:

- [Connector, Commercial, Pin & Socket .093 Dia](#) (PDF, English)

Application Specifications:

- [.093 Diameter Pin and Socket Contacts and Housings](#) (PDF, English)

Instruction Sheets:

- None Available

CAD Files: ([CAD Format & Compression Information](#))

- [2D Drawing](#) (DXF, Version E)
- [3D Model](#) (IGES, Version E)
- [3D Model](#) (STEP, Version E)

Related Products:

- [Tooling](#)
- [Mating Products \(4\)](#)
- [Contacts \(24\)](#)

[List all Documents](#)

Product Features (Please use the Product Drawing for all design activity)

Product Type Features:

- Product Type = Housing
- Gender = Plug
- Number of Circuits = 6
- Mount = Free Hanging
- Lock Type = Detent Lock
- Connector Line = Commercial Pin and Socket
- Color = Natural

Electrical Characteristics:

- Voltage (VAC) = 250

Body Related Features:

- Centerline (mm [in]) = 5.03 [0.198]
- Contact Diameter (mm [in]) = 2.36 [0.093]

Contact Related Features:

- Contact Layout = Matrix

Housing Related Features:

- Housing Material = Nylon
- Housing Flammability Rating = UL 94V-2

Industry Standards:

- [RoHS/ELV Compliance](#) = RoHS compliant, ELV compliant
- [Lead Free Solder Processes](#) = Not relevant for lead free process
- RoHS/ELV Compliance History = Always was RoHS compliant

Packaging Related Features:

- Packaging Method = One Piece Housing

Other:

- Brand = AMP